

Sanimarin® Maxlite+

ELECTRIC MARINE MACERATING PLASTIC TOILET

Part # 065 (12 V) - Part # 067 (24 V)



TECHNICAL SPECIFICATIONS

Voltage/Amperage/Power:

12V, 25A, 300W / 24V, 15A, 360W

Discharge:

10 Ft vertically / 100 Ft horizontally

Discharge pipe diameter:

1" or 1-1/2" (built-in check valve)

Water consumption:

Depends on user

Electrical consumption:

Eco: 12V: 0.007 Ah/s

24V: 0.004 Ah/s

Description:

Plastic marine macerating toilet with built-in self-priming sea water pump.

Weight:

18 Lbs



FEATURES

- **Low profile automatic** macerating plastic toilet system.
- Modern and **lightweight design** with contemporary finish and **quiet operation**.
- **Provided with soft-close toilet seat** and mounting hardware.
- **Equipped** with self priming sea **water pump**.
- Equipped with powerful **stainless steel macerating blade**.
- Provided with **rocker switch** that provides the user full flushing control.

US 800-571-8191
CDN 800-363-5874

Saniflo  SFA GROUP

sanimarin.com

DIMENSIONS

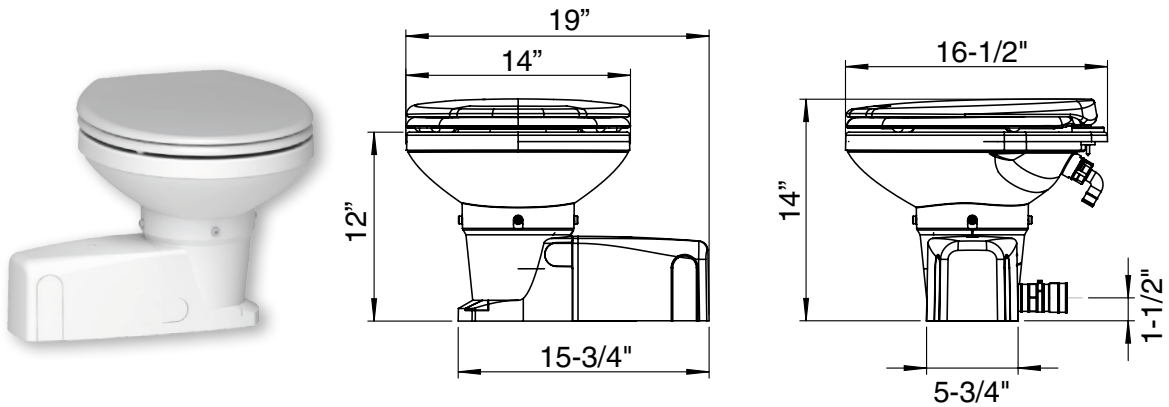

CONTROL SYSTEM

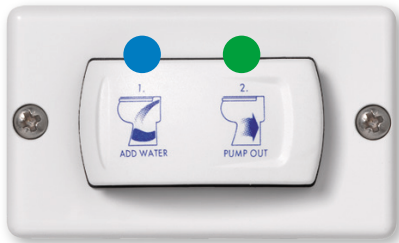

- Add Water: Press to add water before flushing. Press at the end of the cycle to refill trap.
- Pump Out: Press to turn on pump/macerator for complete flushing and discharge..

BENEFITS

