



SANIFLO • MARINE RANGE



BROCHURE
20-21



..... The inventor and world's leading

MANUFACTURER OF MACERATOR TOILETS AT YOUR SERVICE

Founded in 1958, SFA revolutionised the sanitary equipment market by creating the electrical macerator toilet, otherwise known as the Saniflo.

The Group's Marine Range dedicated to the yachting & boating world, wields its extensive expertise in this field to bring you powerful, dependable on-board sanitation systems.

The SFA range of electric marine toilets has been developed with the main objective being to ensure you have the same comfort of use on the water as you have on land.



SFA combines comfort and technology

COMPACT RANGE

Reduced height range, ideal for installing in the smallest spaces, on a raised step or as a replacement for a hand pump toilet.



SN Maxlite+
04 | 05



SN Maxlite+S
06 | 07



SN 31
08 | 09



SN 32
10 | 11



SN Exclusive Short
12 | 13

QUIET RANGE

Quiet toilets that are a standard height so they can be installed at floor level for comfort on board, just like at home.



SN 43
14 | 15



SN Exclusive Medium
16 | 17



SN Exclusive Medium Bidet
16 | 17

PROFESSIONAL RANGE (110V, 220V)

A range of WC units designed especially for boats with a high onboard electrical power capacity.



SN 43
18 | 19



SN 4
18 | 19



SN Exclusive Medium
18 | 19

GREY WATER PUMP

Essential for installing a shower or basin.



SN Pump
20 | 21

CONTROL SYSTEMS AND OPTIONS	22 23
ELECTRICAL AND HYDRAULIC INSTALLATIONS	24 25
TECHNICAL FEATURES	26
ENVIRONMENT	27

A Saniflo unit to replace your manually-operated WC, regardless of its original configuration.



04

TECHNICAL FEATURES

PUMPING HEIGHT	3 m
HORIZONTAL PUMPING DISTANCE	30 m
NON RETURN VALVE	Integrated
OUTLET DIAMETER	38 mm or 25 mm
SUPPLY VOLTAGE	12 V or 24 V DC
MOTOR POWER	300 W (12 V), 360 W (24 V)
ELECTRICITY CONSUMPTION	0,007 Ah (12 V) and 0,004 Ah (24 V) per second (see detail p.26)
WATER CONSUMPTION	Quantity decided by the user
WATER USE	- Sea pump included in the system - Caution : Do not connect the MAXLITE+ toilet to an onboard drinking water or pressurised water system
WEIGHT	8 kg

1 CONTROL SYSTEM



The electric switch Comfort

05



Features SFA macerating technology (stainless steel blade)



Easily replaces a hand pumped toilet



Reversible motor/ pump unit for right or left hand installation



Enables variable positioning of the bowl



External water supply (integrated pump)



Soft close seat



Ultra-light material used for bowl construction

TECHNICAL VIEW



- Sea pump included in the system
- An additional impeller included in the accessory bag

+ Order your maintenance kit separately
Ref. : KITTURBINEMAXLITE

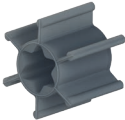

DIMENSIONS (mm)

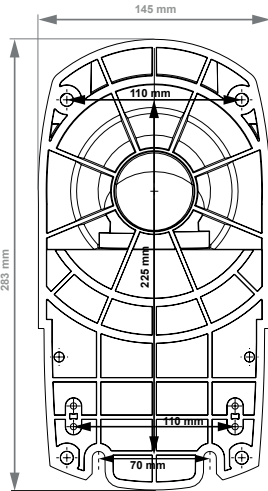
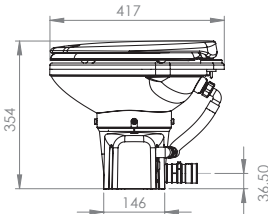
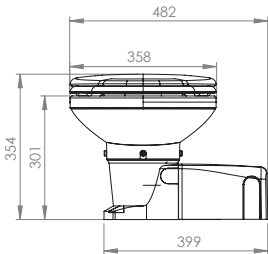

Sanimarin Maxlite

COMPACT RANGE

Thanks to the use of pressurised water on board, this quiet toilet offers maximum comfort. Being ultra-efficient, it can be integrated into all types of configurations.



06

..... MAXIMUM COMFORT

TECHNICAL FEATURES

PUMPING HEIGHT	3 m
HORIZONTAL PUMPING DISTANCE	30 m
NON RETURN VALVE	Integrated
OUTLET DIAMETER	38 mm or 25 mm
SUPPLY VOLTAGE	12 V or 24 V DC
MOTOR POWER	300 W (12 V), 360 W (24 V)
ELECTRICITY CONSUMPTION	0,007 Ah (12 V) and 0,004 Ah (24 V) per second (see detail p.26)
WATER CONSUMPTION	Quantity decided by the user
WATER USE	Integrated solenoid valve for connection to the pressurized water system on board.
WEIGHT	8 kg

1 CONTROL SYSTEM



The electric switch Comfort

07



Features SFA macerating technology (stainless steel blade)



Connection to the pressurised water onboard



Easy to use



Enables variable positioning of the bowl



Reversible motor/ pump unit for right or left hand installation



Soft close seat



Ultra-light material used for bowl construction

TECHNICAL VIEW



Solenoid valve included

DIMENSIONS (mm)

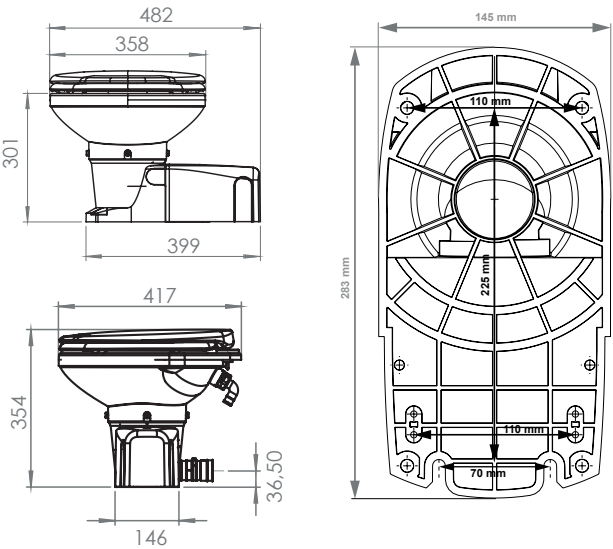

Sanimarin 31

COMPACT RANGE

Thanks to its compact footprint this model fits easily into confined spaces.



08

..... SANIMARIN BESTSELLER

TECHNICAL FEATURES

PUMPING HEIGHT	3 m
HORIZONTAL PUMPING DISTANCE	30 m
NON RETURN VALVE	Integrated
OUTLET DIAMETER	38 mm or 25 mm
SUPPLY VOLTAGE	12 V or 24 V DC
MOTOR POWER	300 W (12 V), 360 W (24 V)
ELECTRICITY CONSUMPTION	Dependent upon the control system (see detail p.26)
WATER CONSUMPTION	Dependent upon the control system from 1.2 L to 2.4 L
WATER USE	- Onboard freshwater (integrated solenoid valve) or outside pressurised water - Minimum pressure of supplied water 1.7 bar - Recommended pump flow rate 11L/min
WEIGHT	17 kg

4 CONTROL SYSTEMS



The electric switch Comfort



Button Comfort Plus



Button Comfort Luxe



The electronic keyboard Luxe

09



Features SFA macerating technology (stainless steel blade)

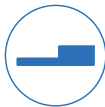

Mounting on a raised step



Small dimensions



Connection to the pressurised water onboard



Easy to use



Quiet



Soft close seat

TECHNICAL VIEWS



Discharge downwards



Other options for discharge

DIMENSIONS (mm)

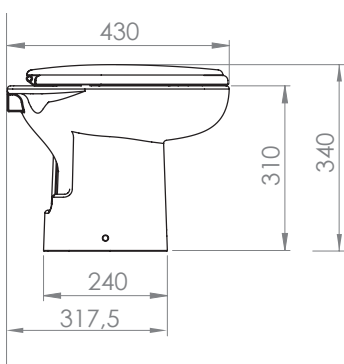
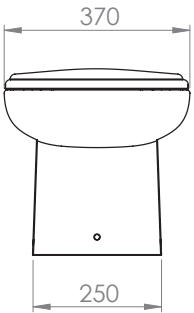

Sanimarin 32

COMPACT RANGE

Easy to install against a vertical partition.



10

..... COMPACT AND COMFORTABLE

TECHNICAL FEATURES

PUMPING HEIGHT	3 m
HORIZONTAL PUMPING DISTANCE	30 m
NON RETURN VALVE	Integrated
OUTLET DIAMETER	38 mm or 25 mm
SUPPLY VOLTAGE	12 V or 24 V DC
MOTOR POWER	300 W (12 V), 360 W (24 V)
ELECTRICITY CONSUMPTION	Dependent upon the control system (see detail p.26)
WATER CONSUMPTION	Dependent upon the control system from 1.2 L to 2.4 L
WATER USE	- Onboard freshwater (integrated solenoid valve) or outside pressurised water - Minimum pressure of supplied water 1.7 bar - Recommended pump flow rate 11L/min
WEIGHT	19 kg

4 CONTROL SYSTEMS



The electric switch Comfort



Button Comfort Plus

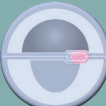

Button Comfort Luxe



The electronic keyboard Luxe

11



Mounting on a raised step



All the system integrated in the foot



Vertical back line



Connection to the pressurised water onboard



Quiet



Soft close seat

TECHNICAL VIEWS



Discharge downwards



Other options for discharge

DIMENSIONS (mm)

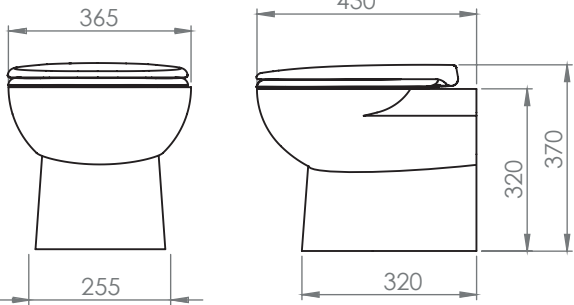

Sanimarin Exclusive Short

COMPACT RANGE

New clean lines for the short model.



12

..... COMPACT AND MODERN DESIGN

TECHNICAL FEATURES

PUMPING HEIGHT	3 m
HORIZONTAL PUMPING DISTANCE	30 m
NON RETURN VALVE	Integrated
OUTLET DIAMETER	38 mm or 25 mm
SUPPLY VOLTAGE	12 V or 24 V DC
MOTOR POWER	300 W (12 V), 360 W (24 V)
ELECTRICITY CONSUMPTION	Dependent upon the control system (see detail p.26)
WATER CONSUMPTION	Dependent upon the control system from 1.2 L to 2.4 L
WATER USE	- Onboard freshwater (integrated solenoid valve) or outside pressurised water - Minimum pressure of supplied water 1.7 bar - Recommended pump flow rate 11L/min
WEIGHT	21 kg

4 CONTROL SYSTEMS



The electric switch Comfort



Button Comfort Plus

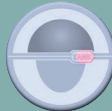

Button Comfort Luxe



The electronic keyboard Luxe

13

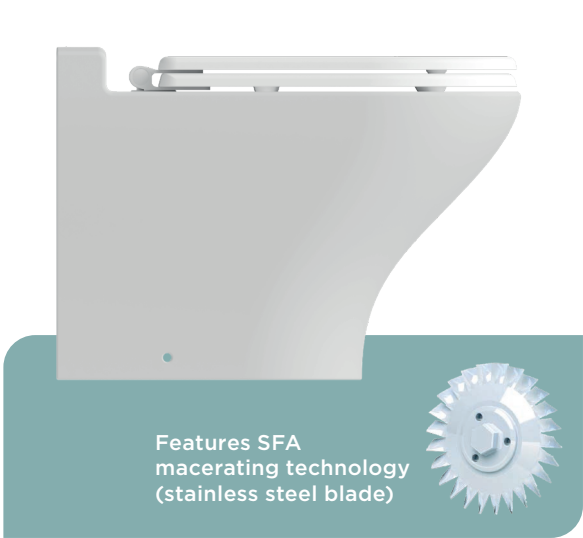

Vertical back line



Comfortable



Contemporary design



A 360° powerful flushing system



Easy to use



Quiet

TECHNICAL VIEWS



Discharge downwards



Other options for discharge

DIMENSIONS (mm)

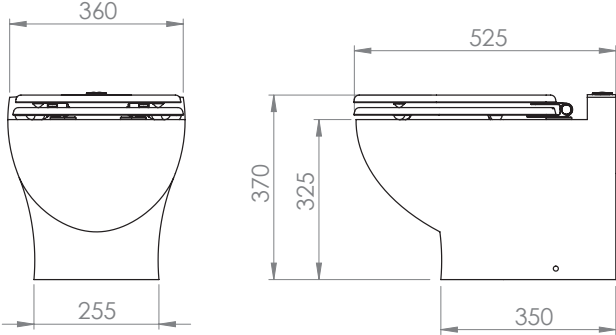

Sanimarin 43

QUIET RANGE

With its pure and simple lines, it fits easily into all spaces.



14

..... COMFORTABLE AND FUNCTIONAL

TECHNICAL FEATURES

PUMPING HEIGHT	3 m
HORIZONTAL PUMPING DISTANCE	30 m
NON RETURN VALVE	Integrated
OUTLET DIAMETER	38 mm or 25 mm
SUPPLY VOLTAGE	12 V or 24 V DC
MOTOR POWER	300 W (12 V), 360 W (24 V)
ELECTRICITY CONSUMPTION	Dependent upon the control system (see detail p.26)
WATER CONSUMPTION	Dependent upon the control system from 1.2 L to 2.4 L
WATER USE	- Onboard freshwater (integrated solenoid valve) or outside pressurised water - Minimum pressure of supplied water 1.7 bar - Recommended pump flow rate 11L/min
WEIGHT	23 kg

4 CONTROL SYSTEMS



The electric switch Comfort



Button Comfort Plus

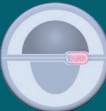

Button Comfort Luxe



The electronic keyboard Luxe

15



Vertical back line



Installation distance from black water tank



Connection to the pressurised water onboard



Quiet Acoustic pressure : 52 dB(A)



Easy to use



Soft close seat

TECHNICAL VIEW



DIMENSIONS (mm)

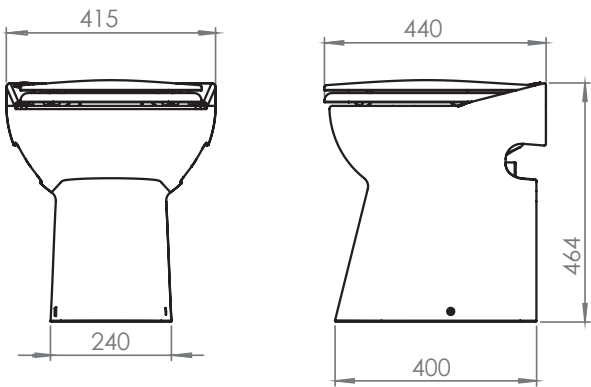

Sanimarin Exclusive Medium

QUIET RANGE

The most luxurious of the range.



16

..... QUIET AND MODERN DESIGN

TECHNICAL FEATURES

PUMPING HEIGHT	3 m
HORIZONTAL PUMPING DISTANCE	30 m
NON RETURN VALVE	Integrated
OUTLET DIAMETER	38 mm or 25 mm
SUPPLY VOLTAGE	12 V or 24 V DC
MOTOR POWER	300 W (12 V), 360 W (24 V)
ELECTRICITY CONSUMPTION	Dependent upon the control system (see detail p.26)
WATER CONSUMPTION	Dependent upon the control system from 1.2 L to 2.4 L
WATER USE	- Onboard freshwater (integrated solenoid valve) or outside pressurised water - Minimum pressure of supplied water 1.7 bar - Recommended pump flow rate 11L/min
WEIGHT	26 kg

4 CONTROL SYSTEMS



The electric switch Comfort



Button Comfort Plus



Button Comfort Luxe



The electronic keyboard Luxe

17



Comfortable



Contemporary design



Vertical back line



A 360° powerful flushing system



Installation distance from black water tank



Quiet
Acoustic pressure : 52 dB(A)

TECHNICAL VIEWS



Exists in a combined toilet/bidet version



Sanimarin Exclusive Medium Bidet delivers economy and space savings thanks to the clever design of the automatic WC combined with the bidet.

DIMENSIONS (mm)

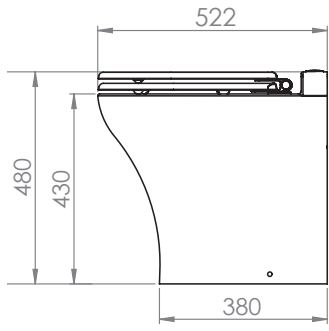

Professional range

110 V - 220 V

A comprehensive range of marine WCs to meet every requirement.



Easy to use



Connection to the pressurised water onboard



Features SFA macerating technology

VIEWS & DIMENSIONS (MM)

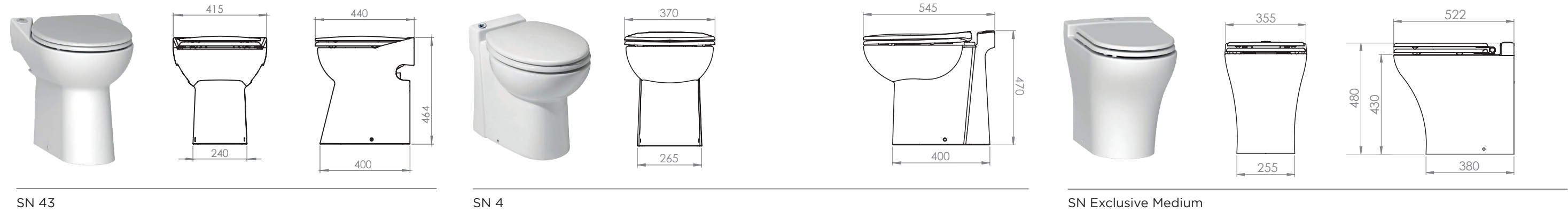

TECHNICAL FEATURES

PUMPING HEIGHT	3 m
HORIZONTAL PUMPING DISTANCE	30 m
NON RETURN VALVE	Integrated
OUTLET DIAMETER	32 mm
SUPPLY VOLTAGE	110 V, 220 V
MOTOR POWER	550 W (220 V), 800 W (110 V)
WATER CONSUMPTION	Eco : 3,6 L / Normal : 5 L
WATER USE	- Onboard freshwater (integrated solenoid valve) - Minimum pressure of supplied water 1.7 bar
WEIGHT	SN 43 : 23 kg SN 4 : 26 kg SN EXCLUSIVE MEDIUM : 26 kg

2 CONTROL SYSTEMS



Pneumatic button Comfort Plus on the WC unit.
Two automatic cycles:
Normal: press once (5l of water)
Eco: press twice rapidly (3.6 L of water)
Press and hold to place the WC in "dry bowl" mode.



Electric button Dual Flush on the WC unit.
Two automatic cycles:
Normal : 5 L.
Eco : 3.6 L.
Press both buttons simultaneously to place the WC in "dry bowl" mode.

Sanimarin Pump

GREY WATER PUMP

Recovers grey water onboard.



20

..... COMPACT AND POWERFUL

TECHNICAL FEATURES

POSSIBLES CONNECTIONS	Sink, shower, washbasin
VERTICAL PUMPING HEIGHT	4 m
EXTERIOR CHECK VALVE	Removable
OUTLET DIAMETER	22 to 32 mm
INLETS	2 low inlets 40 mm (right or left-hand)
ACTIVATION LEVEL	65 mm
MAX WASTE WATER TEMPERATURE	35°C
SUPPLY VOLTAGE	12 V or 24 V
MOTOR POWER RATING	12 V : 70 L/min, I max = 28 A, Pmax = 340 W 24 V : 80 L/min, I max = 15 A, Pmax = 360 W
WEIGHT	3,5 kg



21



Small dimensions

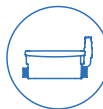

2 low inlets



Odourless Integrated active carbon filter



Low activation level



Quiet - 46 dB(A)



Reduces the number of hull valves

TECHNICAL VIEW

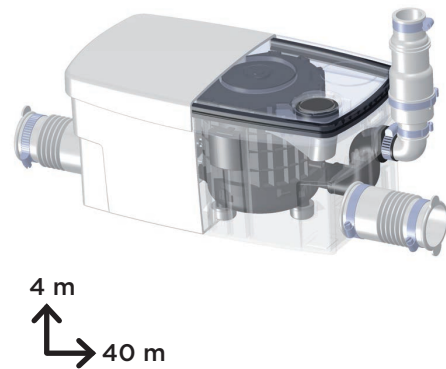

DIMENSIONS (mm)

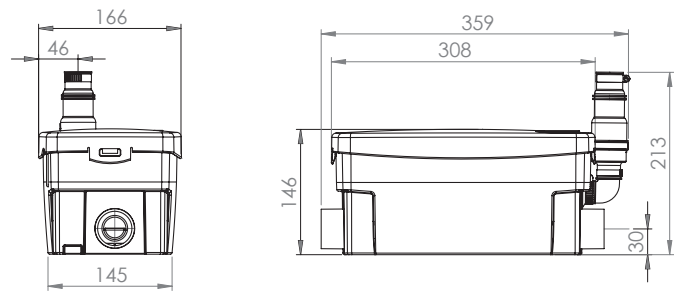

SFA lets you choose the control system you want, no matter what model of toilet you have selected.

THE ELECTRIC SWITCH COMFORT AND WALL MOUNTING KIT

THE ELECTRIC SWITCH COMFORT



- A flushing position
 - A maceration - pumping position
- The duration of each cycle is controlled by the user to suit their requirements.

OPTION

WALL MOUNTING KIT

In cases where it is difficult to recess the controls in the wall, SFA proposes an optional wall mounting screw box for models equipped with electric switch Comfort.



COMFORT PLUS AND COMFORT LUXE BUTTONS

PUSH BUTTON COMFORT PLUS

- Two automatic cycles
2,4 L of rinse water by one single tap
1,2 L of rinse water by 2 successive pushes
- A control Dry Bowl by extended push



ELECTRIC BUTTON COMFORT LUXE

- Two automatic cycles
Normal: 2,4 L of rinse water
Eco: 1,2 L of rinse water
- Dry Mode Bowl: press and hold the Normal mode button
- A Tank indicator light showing that the black water tank is full

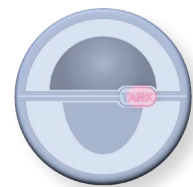

THE ELECTRONIC KEYBOARD LUXE AND FRAME COLOUR OPTIONS

THE ELECTRONIC KEYBOARD LUXE



- Power ON indicator light
- A Normal flushing cycle that uses 2.4 L of water
- An Eco flushing cycle that uses 1.2 L of water
- A Tank Full indicator light showing that the black water tank is full
- Empty: key pressed to empty the bowl completely in choppy seas

OPTION

FRAME COLOUR OPTIONS FOR ELECTRONIC KEYBOARDS LUXE

To make your interior look even better, SFA proposes touchpad frames in different colours.

- Standard: white colour
- All electronic Luxe keyboards are delivered as standard with a white colour frame.
- Options: 3 colours to choose (Grey, Black carbon, Glossy brown).



DIMENSIONS

Electronic control box for following systems:
Luxe, Comfort Luxe, Comfort Plus

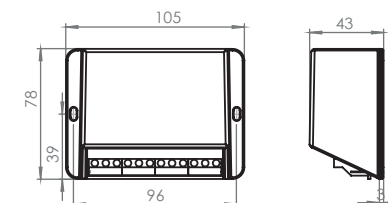

Push button
Comfort Plus

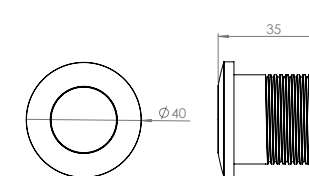

Electric button
Comfort Luxe

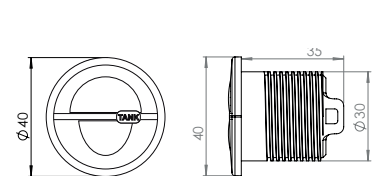

Electronic keyboard
Luxe

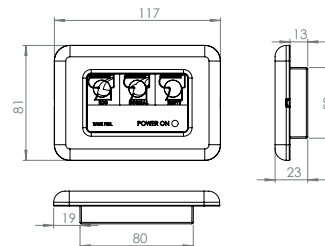

Electric switch Comfort

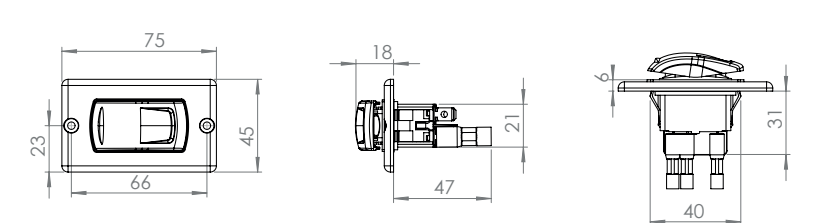

.....Electrical installation

MAXIMUM ELECTRICAL AUTONOMY

Sanimarin solutions consume very little electricity (0.007 Ah per second / 12V).
The energy savings enhance the craft's autonomy, for even greater options.

INSTALLATION DIAGRAMS

Comfort

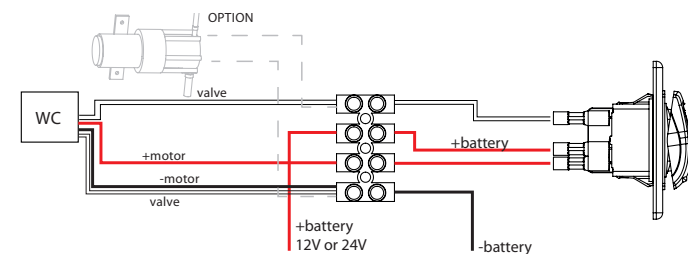

Comfort Plus

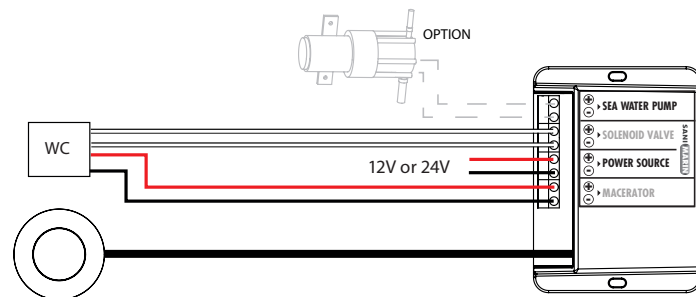

Comfort Luxe

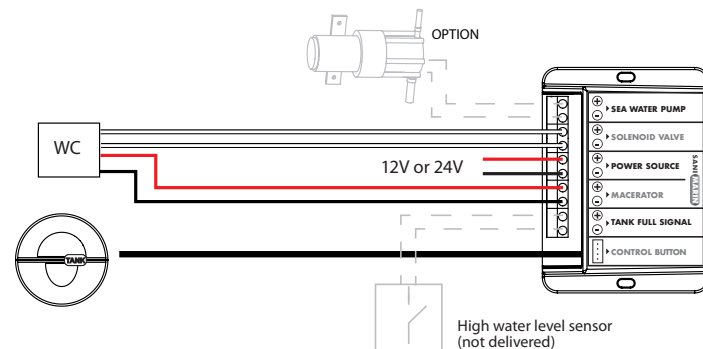

Luxe

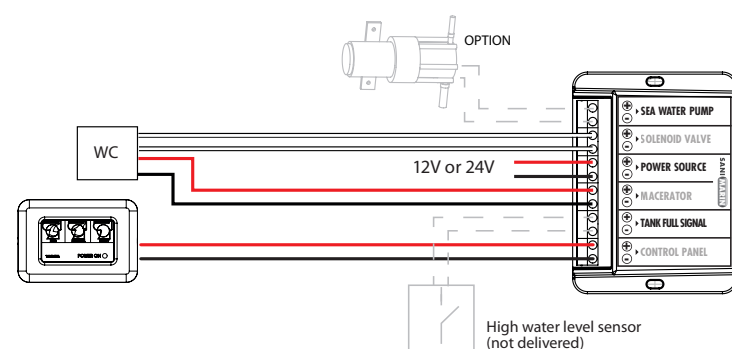

Hydraulic installation.....

WATER, THE MAIN RESOURCE TO BE SAVED

The automatic cycles can be kept very short, with consumption levels of just 1.2 L per cycle. The water used can be freshwater or seawater, to be even more environmentally friendly!

Installation adaptable to all configurations and all types of watercraft.
You can supply your WC with seawater through the optional pump or with fresh water.

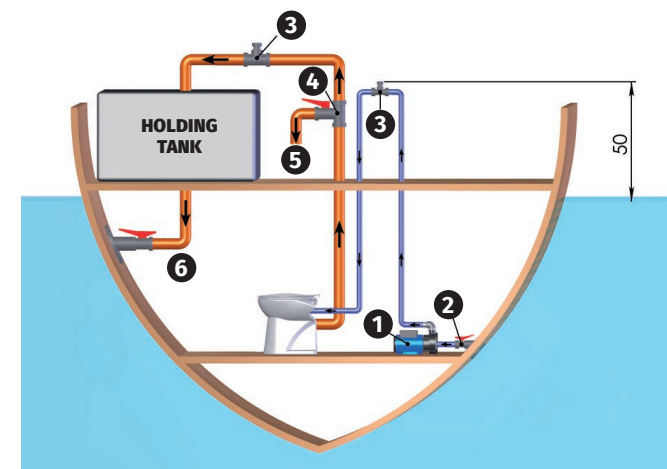

WC below sea level, gravity draining of holding tank

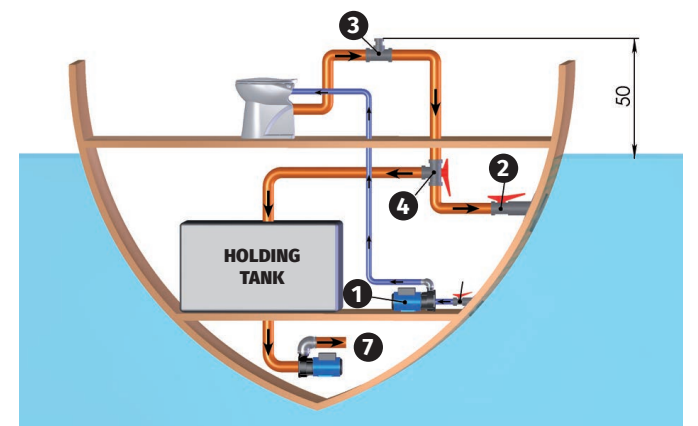

WC above sea level, holding tank below sea level

- 1 Seawater pump
- 2 Stop cock
- 3 Vent
- 4 3 way valve

- 5 Discharge of the toilet direct to the sea
- 6 Gravity drainage to the sea from the holding tank
- 7 Discharge to the sea from the holding tank

OPTION

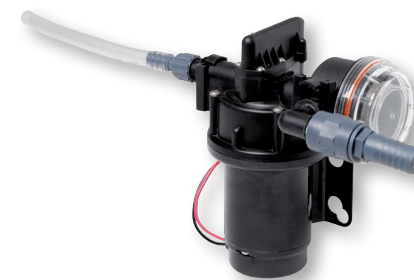







Sanimarin Sea pump

- To provide pumped salt or fresh water for your sanitary fittings directly from outside the boat
- Flow max: 11 L / min
- Maximum suction lift: 2 m

A REGULATORY FRAMEWORK FOR BLACK WATER

The international community as a whole has adopted directives in a number of countries to improve and durably protect water quality.

European directive 94/25 CE regarding boats equipped with toilets notably highlights that the latter “must be equipped with tanks, in other words facilities that can hold tanks”.

								
			SN Maxlite+ / Maxlite+S	SN 31	SN 32	SN Exclusive Short	SN 43	SN Exclusive Medium*
			COMPACT RANGE				QUIET RANGE	
More information			P. 4-7	P. 8-9	P. 10-11	P. 12-13	P. 14-15	P. 16-17
Control systems, more information P. 22-23	Electric switch		•	•	•	•	•	•
	Push button and electric button on the bowl or external for SN 31			•	•	•	•	•
	Electronic keyboard			•	•	•	•	•
Total time required	Electric switch		User's choice					
	Push button and electric button	Eco Normal		8 s / 15 s				
	Electronic keyboard	Eco Normal		8 s / 15 s				
Water consumption	Electric switch		Quantity decided by the user					
	Push button and electric button	Eco Normal		1,2 L / 2,4 L				
	Electronic keyboard	Eco Normal		1,2 L / 2,4 L				
Pumping height			3 m					
Horizontal pumping distance			30 m					
Weight			8 kg	17 kg	19 kg	21 kg	23 kg	26 kg
Minimum pressure			1,7 bar					
Electricity consumption per second	Electric switch		12 V: 0,007 Ah 24 V: 0,004 Ah					
Electricity consumption per automatic cycle	Electronic keyboard / Push button and Electric button	Eco Cycle: 8 s		12 V: 0,056 Ah 24 V: 0,032 Ah				
		Normal Cycle: 15 s		12 V: 0,105 Ah 24 V: 0,060 Ah				
Current consumption	12 V (300 W)		25 A					
	24 V (360 W)		15 A					
Cable sizes	12 V (300 W)		1,5 mm² = 1 m max / 2,5 mm² = 2 m max / 4 mm² = 3 m max / 6 mm² = 4,3 m max					
	24 V (360 W)		1,5 mm² = 3,5 m max / 2,5 mm² = 6 m max / 4 mm² = 9,5 m max / 6 mm² = 14 m max					

* Available in Bidet version, with Luxe keyboard only-weight 28 kg-identical characteristics to SN Exclusive Medium.

Reasons that make SFA products resolutely eco-responsible:

- With lifting capabilities of up to 3 m height and 30 m horizontal distance, SFA marine toilets can evacuate to the black tank wherever its location.
- The efficient maceration system facilitates tank emptying and cleaning.
- The tank's autonomy is also improved by controlling the quantity of flushing water.

SFA PRODUCTS THROUGHOUT THE WORLD

OUR PRODUCTS ARE AVAILABLE FROM 25 SUBSIDIARIES
AND NUMEROUS INTERNATIONAL PARTNERS



- Subsidiaries
- Marine range distributors

SFA
41 bis Avenue Bosquet 75007 Paris
Tél. +33 1 44 82 39 20
sanimarin@sfa.fr

After-sales France
Tél. +33 1 44 82 25 55

www.sanimarin.com



Shaking up water